

## Strut / Channel Nut

**Thread Type:** Metric - Coarse

**Thread Direction:** Right Hand

**Material:** Carbon Steel

**Class Grade:** Low Tensile Class 4.6

**Finish:** Zinc Plated

**Corrosion Protection Level:** Moderate

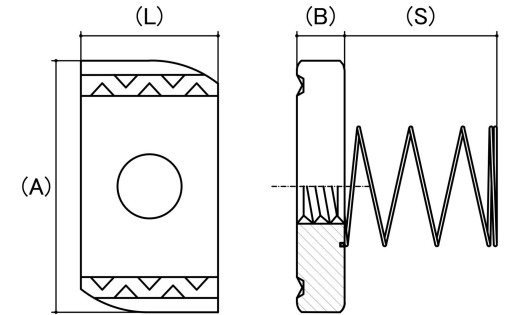

*CAD drawings shown for graphic representation only.\**

Size	Thread Pitch (mm)	Thread Type	Overall Nut Height (B) (mm)		Nut Length (L) (mm)		Nut Width (A) (mm)		Spring length (S) (mm)	sku (qfind)
			Min	Max	Min	Max	Min	Max	Nom	
M6	1.00	Coarse	5.85	6.00	18.00	20.00	34.00	34.60	20.00	41SN6S
M8	1.25	Coarse	7.90	8.10	18.00	20.00	34.00	34.60	20.00	41SN8S
M10	1.50	Coarse	9.10	9.30	18.00	20.00	34.00	34.60	20.00	41SN10S
M12	1.75	Coarse	11.70	11.90	18.00	20.00	34.00	34.60	20.00	41SN12S
M16	2.00	Coarse	10.70	11.40	28.00	30.00	34.00	34.60	20.00	41SN16S

**Disclaimer:**

Dimensional data and technical information was obtained from publically available sources and not acquired through standard agencies. It has been completed and compiled for reference purposes only; where discrepancies are found they are subject to change without notice. Bolt & Nut Australia makes no warranties or representations regarding the accuracy and validity of the compiled information and data. Contact the relevant standard authorities for accurate and detailed information.

\* CAD drawings may not reflect diameter, thread length or overall length.

© Bolt & Nut Australia Pty Ltd. All rights reserved.

Version: 18 Mar 2024